



Biolis 24i Premium

BIOCHEMISTRY ANALYZER
www.cormay.pl



The newest Software makes it possible to take usability a step further



The renewal of user friendly software

- New convenient functions are available, such as check for inappropriate calibration results by flag indication compared to the previous results, and capability of using multiple bottles of the same reagent item on the same tray, etc.

Friendly user-interface

- Real-time display of analysis process, reagent residual volume and so on.



Sharp reduction of reaction volume

- Improvements to the optical measurement system have reduced reaction volume by maximum 30° compared to the former model, BIOLIS 24i.

Sample volume reduction

- Analyzer can test small volume samples (around 50 μ R), effectively, such as those obtained from the elderly or infants.



Night shift mode operation

- Night shift mode enables simpler test.

Simple reagent management

- Automatic reagent residual volume calculation system allows display of real-time residual volume percent.



LAN connection

- Can be connected to an electronic chart of hospital LAN. (Option)

Low noise

- Operation noise is reduced by around 20% compared to BIOLIS 24i.

BIOLIS 24i PREMIUM

Accuracy features

- Individual probes are used for 1st and 2nd reagents to avoid carry-over.
- Sample pre-dilution ratio and auto-rerun dilution ratio can be set in advance.
- Carry-over protection program for reaction cuvettes and probes.
- Detecting function for contaminated reaction cuvettes are available.
- Reagent cooling is available.
- Reaction cuvette washing with heated water and 2 kinds of washing solution (alkaline and acidic) and heated water washing for all probes.

Operation features

- Sample cup and primary tube (5, 7, 10 mR) can be used.
- Auto-gain function when lamp is replaced.
- Reaction waste is stored in a dedicated tank.
- Test result data are compatible with BIOLIS 24i.
- Sampling-stop function using END barcode is available.
- Data base control function is available.
- Improved error list is displayed (compared to BIOLIS 24i).
- Liquid level alarm for water reservoir and waste liquid reservoir is available.

Main unit arrangement

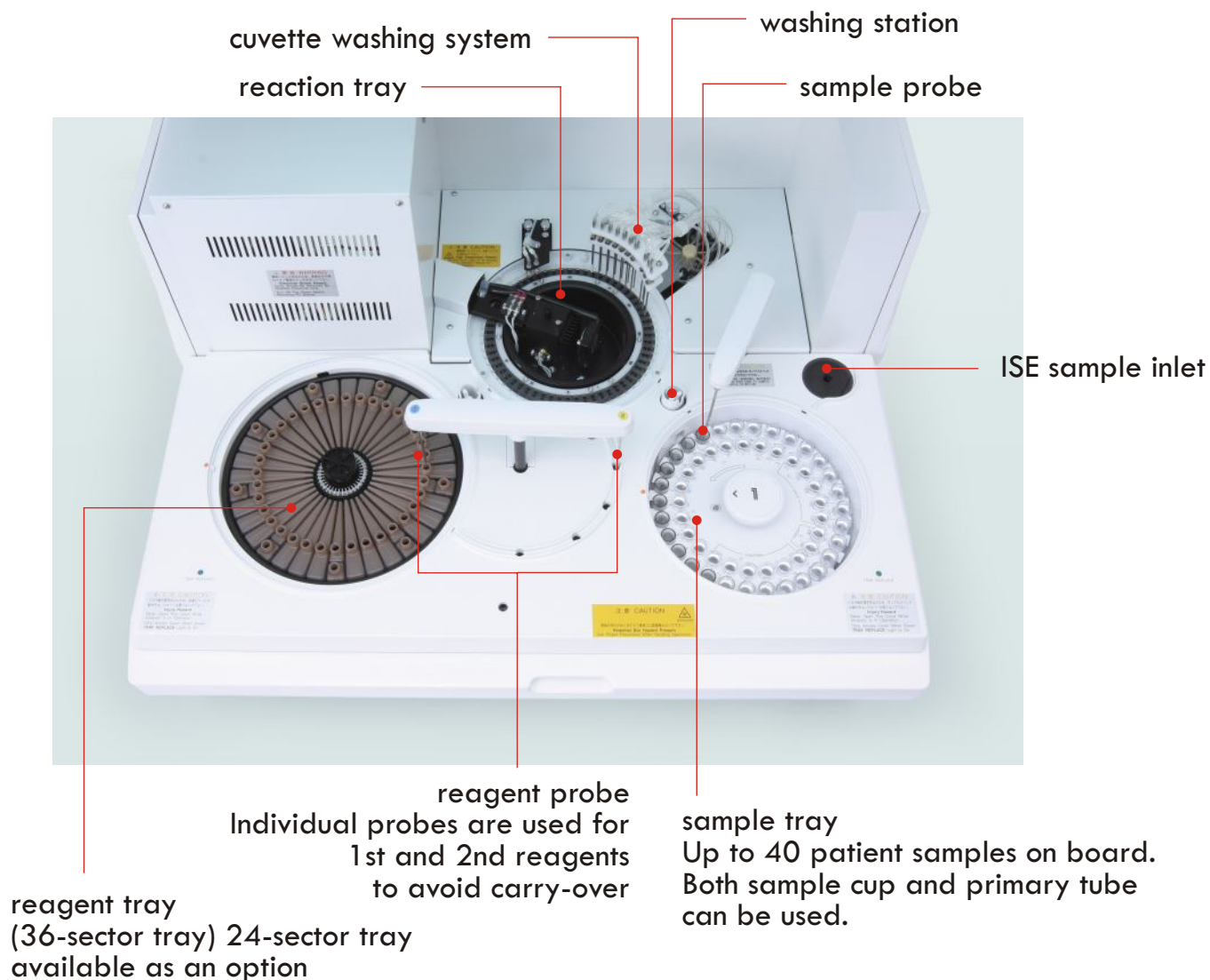

SYSTEM FUNCTION

- **System type:** Automatic reagent biochemical about free access
- **Throughput:** 240 tests/hour, 400 tests/hour including ISE
- **Measuring principles:** Absorbance photometry, Turbidimetry, Ise
- **Analysis method:** End point assay, rate assay, ISE (option), Kinetic, Single / Dual reagent chemistries, monochromatic / bichromatic
- **Programming:** Open system with calibrators and controls defined by user

SAMPLE PROBE

- **Number of sample on board:** Maximum 55/tray
- **Sample dispense volume:** 2.0- 30.0 µl interval at 0,1 µl
- **Sample probe:** Level sensing or count down calculation
- **Cuvette washing:** Auto washing with heated water and 2 kinds of washing solution
- **Automatic sample:** Automatic sample pre-dilution and post-dilution with ratio up to 6, 10-100

INTERNAL BARCODE READER

Barcode reader supplied as an option

REAGENT/ SAMPLES HANDLING

- **Reagent tray:** 36-sectors or 24-sectors (Removable) – temp. $10 \pm 2^\circ\text{C}$
- **Reagent dispense volume: R1 and R2:** 20- 330 µl every 5 µl
- **Sample probe:** Level sensing or count down calculation
- **Reagent probe:** Two separate reagent probes, Level sensing or count down calculation.

REACTION SYSTEM

- **Reaction rotor:** rotating tray with 60 disposable multiple use cuvettes
- **Cuvette washing:** Auto washing with heated water and 2 kinds of washing solution
- **Reaction volume:** Minimum 140 µl, maximum 400 µl
- **Reaction temperature:** $37,0^\circ\text{C} \pm 0,1^\circ\text{C}$
- **Mixing:** Independent mixer

OPTICAL SYSTEM

- **Optical Skurce:** Tungsten halogen lamp (Long-life type)
- **Optical range:** 0-2,5 Abs
- **Photometer:** Tungsten halogen lamp
- **Optical measurement:** 12 fixed wavelengths (340 -800 nm)

ISE MODULE (OPTION)

Selective electrodes: Na⁺, K⁺, Cl⁻

CONTROL AND CALIBRATION

- **Calibration mode:** Linear, Faktor, Logit-Log, Spline, Exponential, Pylonomial
- **Control software:** Westguard multi-rule, XB-R, XE

OPERATION SYSTEM

- **Operation system:** Windows XP
- **Interface:** RS-232 C

WORKING CONDITIONS

- **Power supply:** AC 100/115/230volt (50~60Hz)
- **Environmental conditions:** 15-30°C
- **Humidity:** 35-80% (No condensation)
- **Pure water consumption:** Maximum 3.5R/hour
- **Dimension:** 800mm(w) x 670mm(d) x 520 mm(h)
- **Weight:** Approx. 95kg



PZ CORMAY S.A.

Wiosenna 22 Str, 05-092 Lomianki

tel: 00 48 22 751 79 10

fax: 00 48 22 751 79 11

www.cormay.pl